



We are Solvers and Preventers of Building Envelope Problems

Leak Investigation Process



REVIEW OF PROJECT DOCUMENTS & EVALUATION OF DESIGN CONCEPT

Review any available construction documents and referenced codes and standards.

Evaluate how the building envelope components were designed to resist water infiltration.

DETERMINATION OF SERVICE HISTORY & VISUAL INSPECTION

Gather info on the service history related to the leakage problems. Review of maintenance records, prior remediation attempts, and interviews with personnel.

Inspect as-built current conditions of building envelope systems and document visible water damage.

Property Maintenance Log

Name of Property:	Property Management contact name:
Address:	Email Address:
Property Owner:	Phone Number:

Type of maintenance	Description	Priority Level	Maintenance performed by:	Start date	Co



INVESTIGATIVE TESTING

Perform diagnostic water testing and/or destructive testing to verify hypothesis about the water leakage.

ANALYSIS

Analyze the acquired information to establish a cause and effect relationship between characteristics of the building envelope and observed leakage.

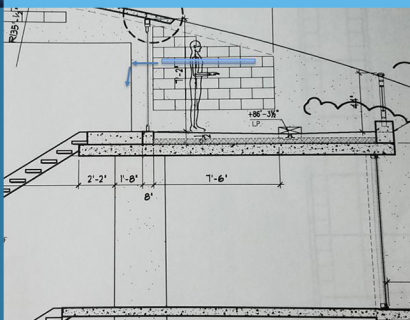

REPORT & RECOMMENDATIONS

Prepare a report describing conditions under which evaluation was conducted, methodology used, observations made, findings and conclusions.



Figure 3: Stairs leading out to roof terrace.



Figure 4: Water damage at stair landing



Figure 5: Water damage under stair landing.



Figure 6: Similar water damage in



GCI CONSULTANTS, LLC

Any questions, please call: 866-690-1909

GCiconsultants.com